

LEGEND

(08) S.A. MODEL; SM-1-12-16

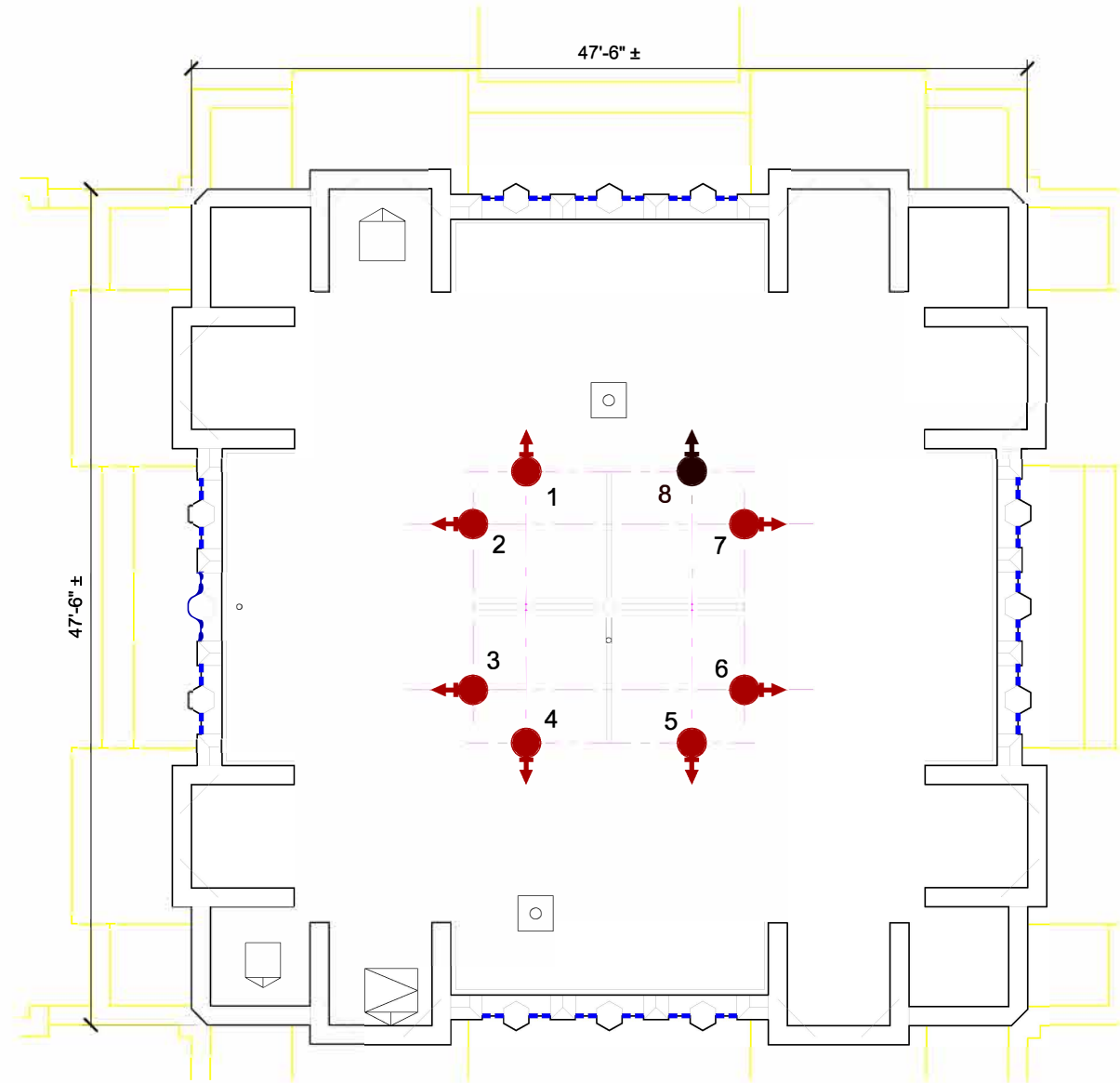

FALL PROTECTION ANCHOR LOCATION PLAN,
PER WISS, JANNEY ELSTNER ASSOCIATES, INC, LAYOUT ON A102, DATE: 05.07.14.
SCALE: N.T.S.

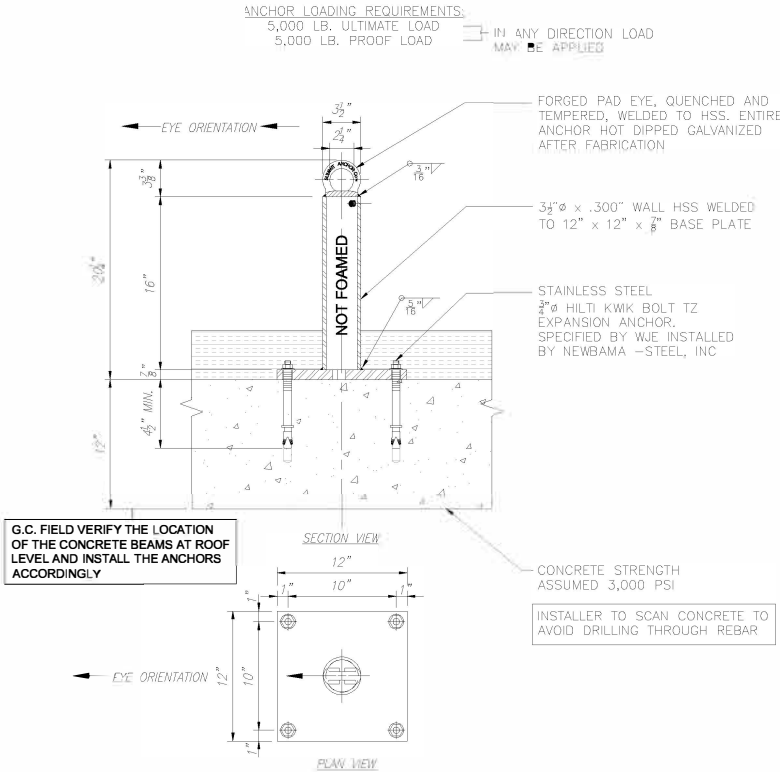

(08) S.A. MODEL; SM-1-12-16
SCALE: N.T.S.

GENERAL NOTES:

1. GENERAL CONTRACTOR, ARCHITECT, AND INSTALLER CHECK IF SUMMIT ANCHOR Co. EQUIPMENT SHOWN ON THIS DRAWING IS OBSTRUCTED BY ROOF EQUIPMENT. REPORT OBSTRUCTIONS THAT WOULD FOUL LINES WHEN TIED-BACK TO ANCHORS. DO NOT PROCEED WITH INSTALLATION UNTIL ALL UNSATISFACTORY CONDITIONS, INCLUDING OBSTRUCTIONS, HAVE BEEN RESOLVED.
2. ANCHOR PLAN DIMENSIONS MAY BE APPROXIMATE AND NEED TO BE VERIFIED ON SITE.
3. FOR ORIENTATION OF ANCHOR EYE SEE PLAN.
4. SUMMIT ANCHOR Co. IS NOT RESPONSIBLE FOR THE SAFETY OF THE PARAPET WALL OR ANY OTHER PART OF THE BUILDING WHEN USED IN CONJUNCTION WITH SUMMIT ANCHOR Co. EQUIPMENT.

ARCHITECTURAL/ENGINEER NOTES:

1. SUMMIT ANCHOR Co. ANCHORS ARE MANUFACTURED TO SUPPORT THE LOADS INDICATED BELOW.

a) ANCHORAGE SHALL BE CAPABLE OF SUSTAINING A MINIMUM ULTIMATE LOAD OF 5,000 LB. IN ANY DIRECTION THE LOAD MAY BE APPLIED, WITHOUT FRACTURE, FAILURE, AND PERMANENT DEFORMATION OR DAMAGE TO ANCHORAGE.

b) ANCHORAGE SHALL BE CAPABLE OF SUSTAINING A MINIMUM PROOF LOAD OF 5,000 LB. IN ANY DIRECTION THE LOAD MAY BE APPLIED, WITHOUT FRACTURE, FAILURE, AND PERMANENT DEFORMATION OR DAMAGE TO ANCHORAGE.
2. THE INSTALLED ANCHORS SHALL BE TESTED UNDER THE SUPERVISION OF A P.E. FOR VERIFICATION.
3. IT IS THE RESPONSIBILITY OF THE STRUCTURAL ENGINEER OF RECORD (OF THE OVERALL PROJECT) TO DESIGN AND ADD ADDITIONAL STRUCTURAL STEEL BRACING, REINFORCING BAR, ETC., AS THE E.O.R. DEMS NECESSARY SO THAT THE ROOF FRAME STRUCTURE CAN ADEQUATELY WITHSTAND THE ABOVE LOADS, IN ANY DIRECTION THESE LOADS MAY BE APPLIED.

ANCHOR MATERIALS:

- a) HSS SECTIONS ARE ASTM A500 GRADE C. (FY=46 KSI)
- b) FORGED PAD EYES ARE AISI 1030 PER ASTM 576-90-b. (FY=72 KSI)
- c) STAINLESS STEEL FORGED PAD EYES ARE 304 SS (FY=35 KSI)
- d) STEEL PLATES ARE A572 GR. 50 (FY=50 KSI) U.N.O.
- e) STAINLESS STEEL FASTENERS ARE TYPE 304 U.N.O

INSPECTION AND TESTING:

1. SUMMIT ANCHOR Co. EQUIPMENT SHOWN ON THIS DRAWING IS NOT APPROVED FOR USE UNTIL CERTIFIED BY A LICENSED, PROFESSIONAL ENGINEER. RECERTIFICATION IS REQUIRED AT PERIODS NOT TO EXCEED 10 YEARS (5 YEARS FOR EQUIPMENT INSTALLED WITH EPOXY OR ADHESIVE FASTENERS) OR WHEN REROOFING THE BUILDING. CERTIFICATION AND RECERTIFICATION OF EQUIPMENT SHALL BE DONE BY A LICENSED PROFESSIONAL ENGINEER. AFTER INITIAL CERTIFICATION SUMMIT ANCHOR Co. EQUIPMENT SHALL BE INSPECTED ANNUALLY BY A QUALIFIED PERSON. A COPY OF THE CERTIFICATION LETTER AND SUBSEQUENT ANNUAL INSPECTION REPORTS SHALL BE KEPT BY BUILDING MANAGEMENT IN THE BUILDING'S MAINTENANCE LOG BOOK.
2. ANY SUMMIT ANCHOR Co. EQUIPMENT SUBJECTED TO IMPACT LOADING (FALL ARREST) OR OTHER POSSIBLE STRUCTURAL DAMAGE SHALL BE REMOVED FROM SERVICE UNTIL THE EQUIPMENT IS INSPECTED BY SUMMIT ANCHOR Co. OR A STRUCTURAL ENGINEER. THIS INSPECTION SHALL BE VERIFIED IN WRITING TO THE BUILDING MANAGEMENT BEFORE SAID EQUIPMENT IS PUT BACK IN SERVICE. DAMAGED EQUIPMENT SHALL BE REPLACED AS SPECIFIED BY SUMMIT ANCHOR Co. OR A STRUCTURAL ENGINEER.

USER NOTES:

1. INDIVIDUALS USING EQUIPMENT-SUPPLIED BY SUMMIT ANCHOR-SHALL BE TRAINED AND COMPETENT IN THE SAFE USE OF SUCH EQUIPMENT, INCLUDING RIGGING AND FALL PROTECTION.
2. SUMMIT ANCHOR Co. EQUIPMENT SHALL BE INSPECTED BY A QUALIFIED PERSON BEFORE EACH USE.
3. SUMMIT ANCHOR Co. EQUIPMENT SHALL BE USED IN ACCORDANCE WITH THE FOLLOWING:
 - a) OSHA 1910, SUBPART D (WALKING AND WORKING SURFACES)
 - b) OSHA 1910, SUBPART F (POWERED PLATFORMS)
 - c) OSHA 1910.66 APPENDIX C (PERSONAL FALL ARREST SYSTEMS)
 - d) OSHA PROCEDURES AND PRECAUTIONS FOR EMPLOYEES USING DESCENT CONTROL EQUIPMENT.
 - e) ANSI/IFCA I-14.1-2001 (WINDOW CLEANING SAFETY STANDARD)
 - f) ANSI Z359. 2007 AMERICAN NATIONAL STANDARD (SAFETY REQUIREMENTS FOR PERSONAL FALL ARREST SYSTEM, SUBSYSTEMS AND COMPONENTS)
4. WORKERS SHALL BE PROPERLY SECURED TO A SAFETY LINE THAT IS PROPERLY ATTACHED TO A CERTIFIED ANCHOR BEFORE APPROACHING WITHIN SIX FEET OF THE ROOF EDGE UNLESS A MINIMUM 42" PARAPET OR GUARDRAIL IS PROVIDED.
5. ALL ROPES MUST BE PROTECTED FROM ABRASION OR WEAKENING RESULTING FROM CONTACT FROM SURFACES.
6. IT IS THE RESPONSIBILITY OF THE EMPLOYER TO PROVIDE THE CORRECT PFF EQUIPMENT BASE ON THE WORK PERFORMED.

PROJECT

LANDMARK CENTER
401 PARK DRIVE
BOSTON, MA 02115

JOB#: 0605

PREPARED FOR

NEWBAMA STEEL INC.
213 HAVERHILL ROAD
EAST KINGSTON, NH
603.382.2261

BY

Summit Anchor Company
4507 METROPOLITAN CT.
SUITE F
FREDERICK, MD 21704
TEL: 800.372.1098
FAX: 301.620.9819

ENGINEER/CONSULTANT

D.H. CHARLES
ENGINEERING, INC.
4706 HOEN AVENUE
SANTA ROSA, CA 95405
TEL: 707.537.8282
FAX: 707.537.8338

DATES & REVISIONS

DRAWN BY:	P.A.	01/13/14
CHECKED BY:	G.S.	DATE
APPROVED BY:	J.Y.	DATE

DRAWING TITLE

FALL PROTECTION
ANCHOR LOCATION PLAN,
PER WISS, JANNEY
ELSTNER ASSOCIATES,
INC, LAYOUT ON A102,
DATE: 05.07.14.

PROFESSIONAL CERTIFICATION

DATE APPROVED:

THE ENGINEER'S SEAL SIGNIFIES ONLY THAT THE PRODUCTS PROVIDED BY SUMMIT ANCHOR Co.
A. WILL WITHSTAND THE LOADS INDICATED ON THIS DRAWING WHEN ANALYZED BY ACCEPTED ENGINEERING STANDARDS OR
B. HAVE BEEN TESTED FOR THE INDICATED LOADS.

DRAWING NUMBER

A-1